



**BWP** **PREMIER**  
**BEST WESTERN.**

Welcome to the Best Western Premier Waterfront Hotel and Convention Center. The beautiful facility is conveniently located on the banks of the Fox River in downtown Oshkosh and hosts a variety of first class amenities.

The Best Western Premier Waterfront Hotel has 176 guest rooms including eight suites. Most rooms have picturesque waterfront views. The hotel is connected by skywalk to the Oshkosh Convention Center with a combined total of 25,000 square feet of flexible meeting space. The locally popular Ground Round at River's Edge is located inside the hotel. Guests can enjoy breakfast, lunch and dinner overlooking the river and if the weather permits, dine outside along the riverwalk.

Our professional meeting and banquet staff are available to assist with every aspect of planning your event. The experienced culinary team will create delicious cuisine that is guaranteed to impress! Let us exceed your expectations!

**BWP**  
**PREMIER**  
**BEST WESTERN.**

**Waterfront Hotel and Convention Center**

(855) 230-1900

(920) 230-1900

1 N. Main Street • Oshkosh, WI 54901

[www.bwoshkosh.com](http://www.bwoshkosh.com)

**Welcome To The Premier Life.®**

Each Best Western® branded hotel is independently owned and operated.



# BWP PREMIER

## BEST WESTERN®

- TripAdvisor #1 Hotel 2013-present
- 176 beautifully appointed guest rooms
- Over 25,000 square feet of meeting space for up to 1600 guests
- Up to 19 breakout rooms
- Full-service catering team to assist with both on-site and off-site events
- Complimentary high-speed WI-FI
- Microwave, refrigerator, coffee maker, and safe in each room
- Ask about Best Western Rewards Program
- State-of-the-art business center
- Ground Round at River's Edge Restaurant & Bar with outdoor seating and fire pit
- Oshkosh public riverwalk and boat dock just steps from the hotel

**Waterfront Hotel and Convention Center**  
(920) 230-1900 • (855) 230-1900  
[www.bwoshkosh.com](http://www.bwoshkosh.com)

**Welcome To The Premier Life.®**



**Best Western Premier**  
WATERFRONT HOTEL AND CONVENTION CENTER

**Room Capacities**

Convention Center	Square Footage	Banquet	Classroom	Theater	Conference	U-Shape	8'x10' Exhibits
Enitre Conference Hall	15,400	1,200	880	1,300	N/A	N/A	100
South Half (Leander Choate, Lynch, Lefevre, Dixie)	7,700	500	456	800	96	87	49
North Half (Paul L, BF Carter, Anna M, Evelyn)	7,700	500	456	800	96	87	49
Paul L	5,180	400	304	550	N/A	108	35
Leander Choate	5,180	400	304	550	N/A	108	35
B.F. Carter	840	60	48	84	32	32	5
Anna M	840	60	48	84	32	32	5
Evelyn	840	60	48	84	32	32	5
John Lynch	840	60	48	84	32	32	5
Lefevre	840	60	48	84	32	32	5
Dixie	840	60	48	84	32	32	5
Thistle	790	50	48	84	32	28	5
Henrietta	905	60	56	96	32	32	5
K.M. Hutchinson	950	60	56	96	32	32	5
Oshkosh Corporation Board Room	465	20	N/A	35	12	-	-

Hotel	Square Footage	Banquet	Classroom	Theater	Conference	U-Shape	8'x10' Exhibits
Athearn Ballroom (ABC)	3,500	224	208	360	66	-	22
Athearn A	875	54	42	90	30	30	5
Athearn B	875	54	42	90	30	30	5
Athearn C	1,730	112	96	165	36	45	12
Lake Winnebago (A/B)	880	56	39	72	36	33	5
Lake Winnebago A	440	24	24	32	12	9	-
Lake Winnebago B	440	24	24	32	12	9	-
Lake Poygan	475	32	32	40	18	15	-
Lake Butte des Morts	440	16	8	20	12	-	-
Foundation Board Room	532	N/A	N/A	N/A	12	-	-



**HOTEL MAIN ENTRANCE  
GROUND LEVEL**

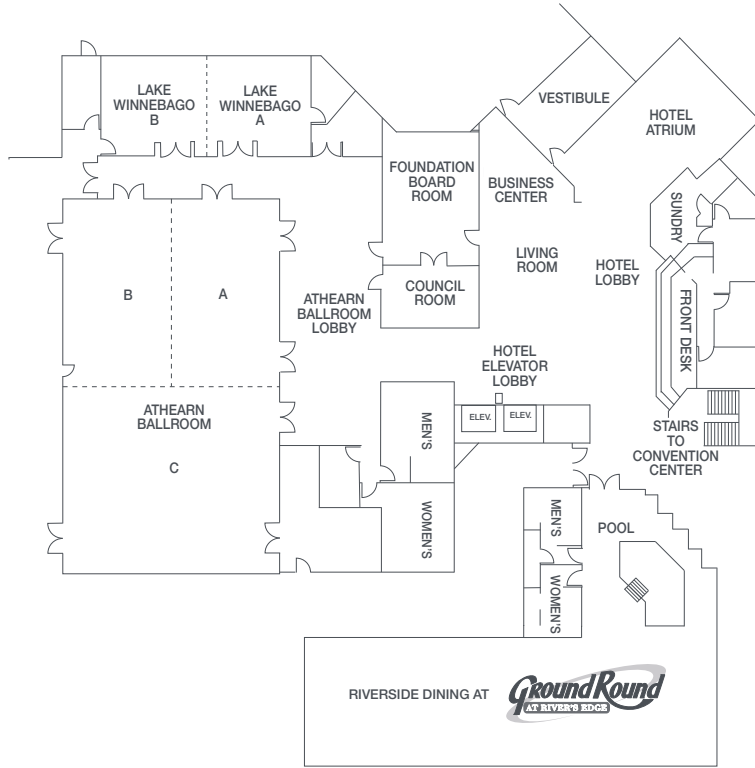

**CONVENTION CENTER  
GROUND LEVEL**

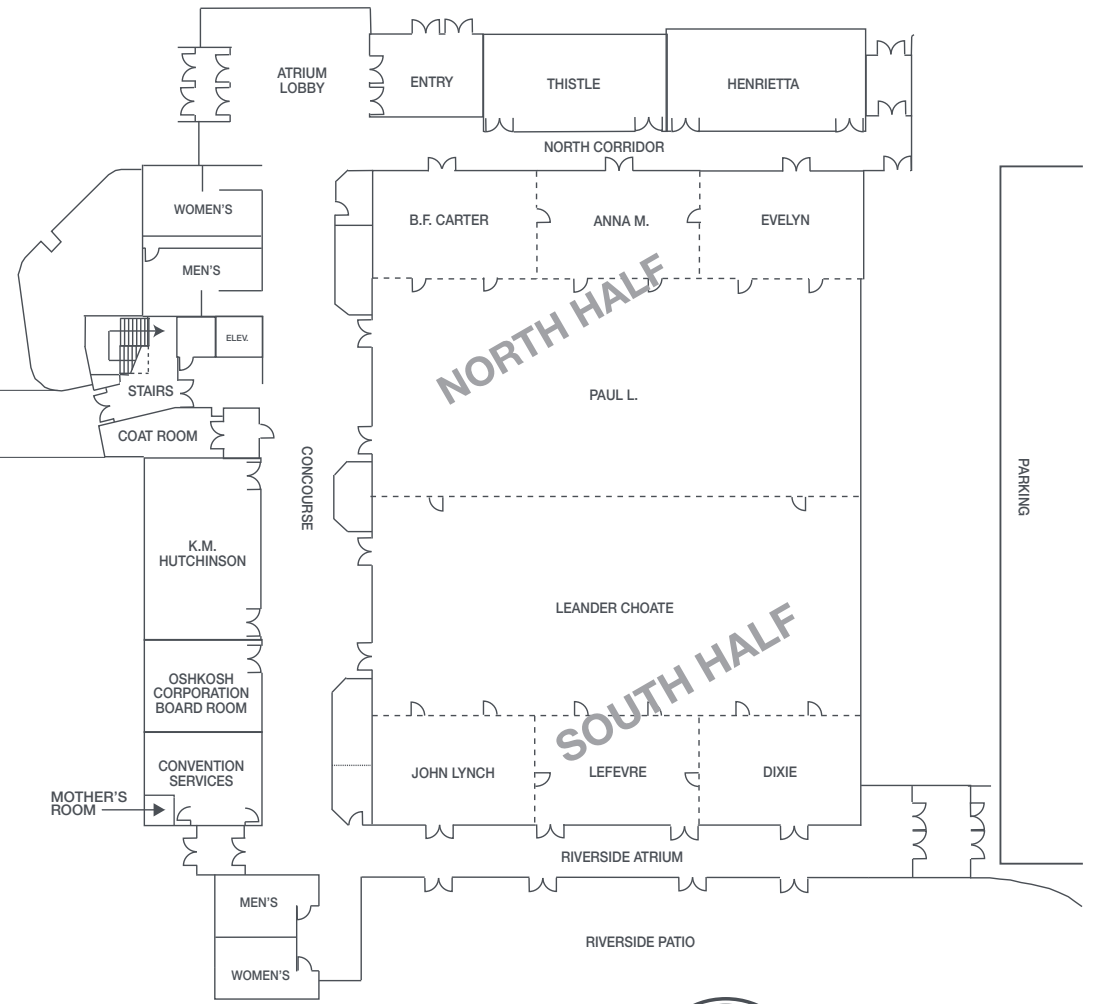

**HOTEL LEVEL 2**

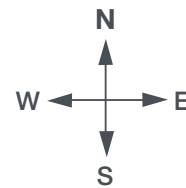
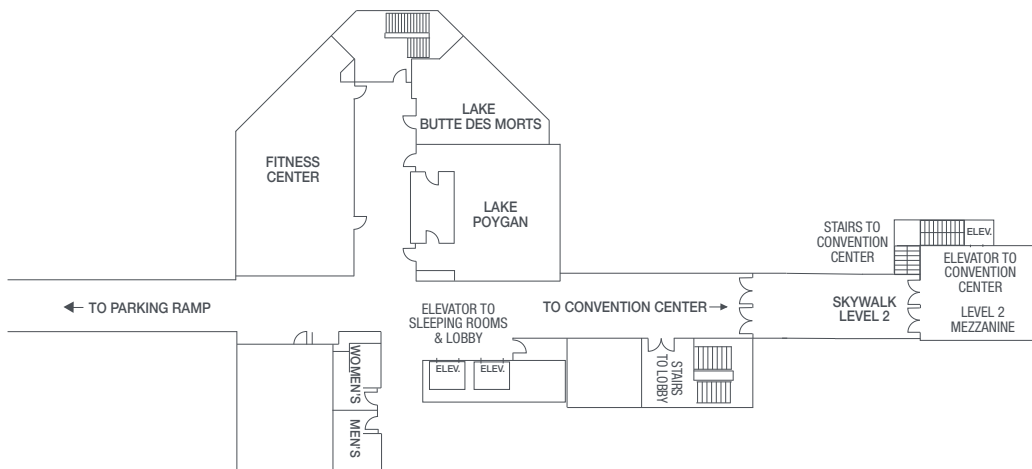

**BWP**  
**PREMIER**  
**BEST WESTERN.**  
**Waterfront Hotel  
 and Convention Center**